

Bumper-C



Freight transport is constantly evolving. It has to be flexible, profitable and fast. This means that vehicle bodywork is severely put to the test. Repeated docking operations, access difficulties and meeting tight schedules often result in damage to the rear end of vehicles.

To help carriers avoid damage-related costs (vehicle repairs and downtime), the CHEREAU R&D teams have developed the Bumper-C.



The solution

The Bumper-C is the solution for limiting damage to the rearend of haulage vehicle bodywork. Its innovative design enables it to absorb the energy of any impact by acting as a shock absorber.

The Bumper-C also allows loads to be freely raised and lowered when the bodywork is resting on the loading bay, without any risk of it being dislodged or distorted.

The benefits

The Bumper-C is the patented result of work carried out by the CHEREAU R&D department and has been thoroughly tested both in laboratories and in actual use. It is highly effective and significantly reduces impact-related damage.

Positioned symmetrically on the rear end of the chassis, the two steel Bumper-C units combine good looks and strength.

The Bumper-C can be fitted on all CHEREAU semi-trailer chassis, as well as on many chassis-cabs of other constructors, whatever the equipment fitted (tail lifts, wheel carriers, boxes, hydraulic gantries, etc.).

Bumper-C enables carriers to make savings on maintenance costs and fit their vehicles with a CHEREAU quality-assured innovation, which ensures optimal, rear-end resistance to guarantee both thermal performance and, therefore, performance of the transported freight.

Bumper-C



> Semi-trailer Bumper-C

• European patent registration.

• Steel system support arm fixed laterally on the outside of the chassis, connecting all the parts of the Bumper-C to the chassis.

• Silentbloc acts as a shock absorber, absorbing most of the impact energy.

• The suspension arm protects the Silentbloc and supports the pair of galvanized steel rollers.

> The Bumper-C is available as an option on all CHEREAU semi-trailer chassis, with or without rear lifting platforms.

If required for a CHEREAU semi-trailer already in use, the Bumper-C is distributed by CHEREAU Services and may only be fitted by an approved Service Agent.

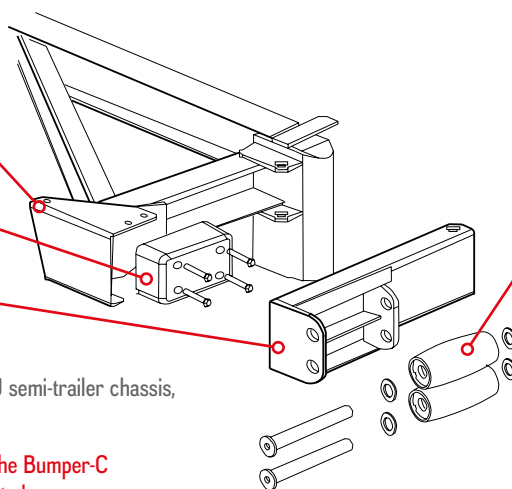

• 2 rollers of optimal shape to make contact with the bay, even at an angle. Rollers made of galvanized steel and freely mounted on an axle, enabling them to rotate during raising and lowering manoeuvres, when the trailer is in contact with the bay.

> Truck Bumper-C

• European patent registration.

• Steel system support arm fixed laterally on the outside of the chassis, connecting all the parts of the Bumper-C to the chassis.

• Steel «slide case» houses and protects the Silentbloc.

• Silentbloc acts as a shock absorber, absorbing most of the impact energy transmitted through the push-rod.

> The Bumper-C is available for all chassis-cabs, with or without rear lifting platforms, of all constructors, although some exceptional configurations may require preliminary technical validation.

The truck Bumper-C is distributed by CHEREAU Services and may only be fitted by an approved Service Agent.

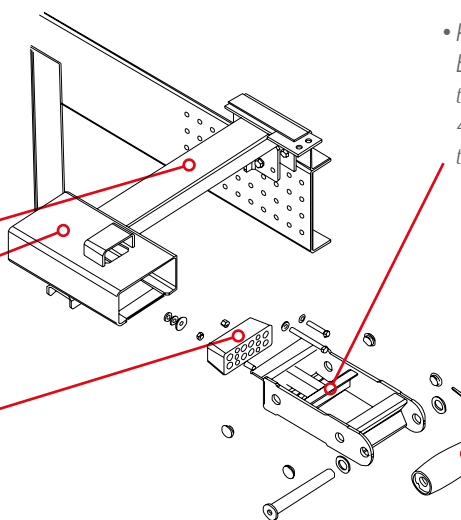

• Push-rod: the central element of the truck Bumper-C. It transfers the shockwaves to the Silentbloc and supports the roller. 4 brass push-rod guides ensure that the push-rod slides smoothly in the case.

• The galvanized steel roller is freely mounted on an axle, allowing it to rotate during raising and lowering manoeuvres, when the trailer is in contact with the bay.



INNOVATION DRIVES YOU FORWARD